

# Fabhp Hub Assembly

For AMAT HP and HP+ robots

**The Fabhp hub assembly improves bearing lifetime and wafer placement repeatability while reducing particles and motor sync errors.**

- Hybrid ceramic hub bearings increase product life span and reduce particle generation
- Integral shields increase race stiffness and help retain lubricant to further reduce particles
- Patented stainless steel hub spacers provide stiffness against twisting and distorting
- Increased spring force keeps the hub assembly vertically aligned to ensure bearing stability and reduce robot droop
- Upper and lower bearing spacers are pinned together to eliminate lateral motion during robot movement and improve wafer placement repeatability
- Upper and lower motors are locked in place with specifically designed brackets to eliminate motor jumping and twisting and improve wafer placement repeatability

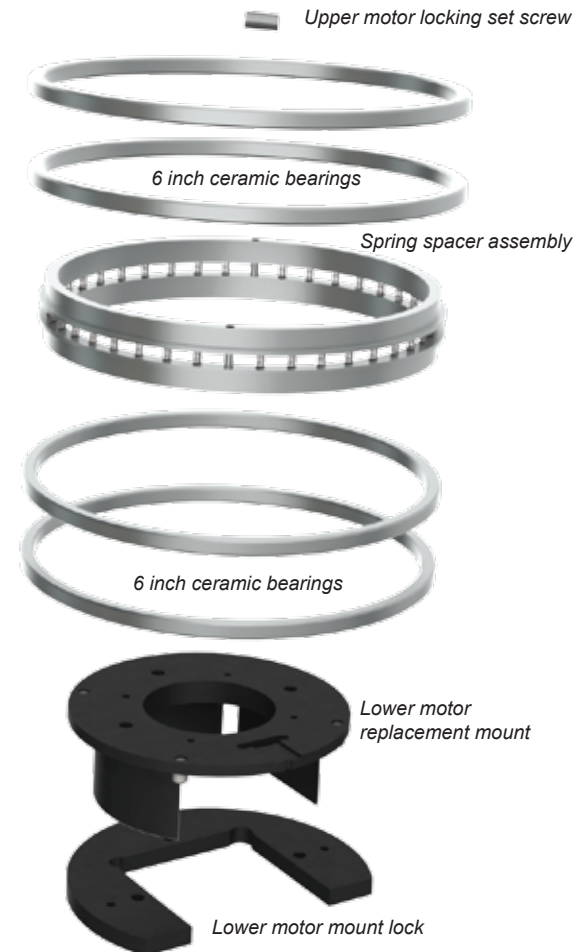

Fabworx is a trademark of Fabworx Solutions, Inc.

## FABWORX SOLUTIONS, INC.

innovative hardware solutions for your fab equipment

phone 512.870.9191  
web [www.fabworx.com](http://www.fabworx.com)  
email [info@fabworx.com](mailto:info@fabworx.com)

FABWORX SOLUTIONS, INC.  
**Fabworx**™